

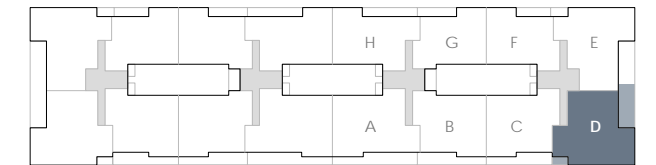

Residencial
Amadeus



e 1/75 0 1 2 3 4

vivienda D
 (plantas 1ª a 6ª)

superficies útiles

| | |
|--------------------------|-----------------------------|
| recibidor | 6,07 m ² |
| pasillo | 6,21 m ² |
| estar-comedor | 29,03 m ² |
| cocina | 13,52 m ² |
| dormitorio 1 | 19,15 m ² |
| dormitorio 2 | 11,00 m ² |
| dormitorio 3 | 11,13 m ² |
| dormitorio 4 | 12,51 m ² |
| baño 1 | 5,52 m ² |
| baño 2 | 3,92 m ² |
| sup. útil cerrada | 118,06 m² |

| | |
|--------------------------|----------------------------|
| tendedero | 3,52 m ² |
| terracea | 17,32 m ² |
| sup. útil abierta | 20,84 m² |

total sup. útil 138,90 m²